



Taxi

D&T

Ways of fixing axles to a chassis:

Fixed axles

Fixed axles cannot move but the wheels turn freely. Axles on models can be fixed in place using clothes pegs or masking tape.

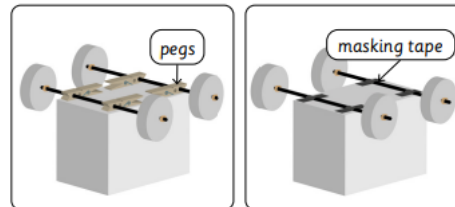

Moving axles

Moving axles turn freely so the wheels are fixed to them. Moving axles can be held in place with cardboard tabs or pushed through holes in the chassis.

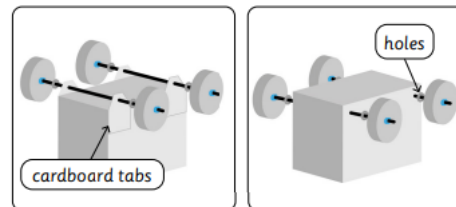

A **wheel** is a circular object that is joined to an axle.

A **chassis** is the frame of a vehicle.

An **axle** is a rod that goes through the centre of a wheel and allows it to turn.

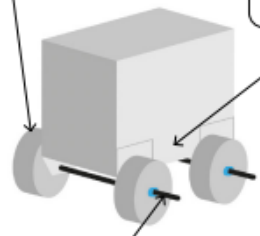

Taxis:

Taxis are vehicles that carry passengers from one place to another. A taxi has a chassis, wheels and axles. It also has seats inside, a roof, windows and headlights.



Glossary

Axle: A rod on which one or more wheels can rotate.

Chassis: The frame on which a vehicle is built.

Design: To plan and draw something before it is made.

Evaluate: To say what is good about a product and what could be improved.

Wheels: A circular object that turns around.